

## Table of Contents

Tools and Equipment Pictorial Index . . . . . 518

*Hydraulics*

30A Hydraulic Press . . . . . 521  
 60AGSC and 60AFTGSC Hydraulic Press . . . . . 522  
 60S/DC Hydraulic Press . . . . . 523  
 100A Hydraulic Press . . . . . 524  
 15GBM Gas Hydraulic Pump . . . . . 525  
 30GBM Gas Hydraulic Pump . . . . . 526  
 30GHR Gas Hydraulic Pump . . . . . 527  
 PE-NUT Electric Two-Speed Pump . . . . . 528  
 Hydraulic Hoses . . . . . 529

*Compression Dies*

AH and SH Compression Dies—B Series . . . . . 530  
 AH, CD and SH Compression Dies—30 Ton Series . . . . . 531  
 AH, SH and GW Compression Dies—60 Ton Series . . . . . 532  
 AH and SH Compression Dies—100 Ton Series . . . . . 533  
 CD Compression Dies—B Series . . . . . 534  
 CD Compression Dies—60 Ton Series . . . . . 535  
 CD Compression Dies—100 Ton Series . . . . . 536

*Tools and Equipment Reference Materials*

Pump and Press Combinations . . . . . 537  
 Tool Safety Information . . . . . 538  
 Warranty . . . . . 539

Pictorial Index

PICTORIAL INDEX

<b>TOOLS AND EQUIPMENT</b>	
<p><b>30-Ton Hydraulic Press</b> pg. 520</p> 	<p><b>Gas Hydraulic Pumps (Remote Control)</b> pgs. 526</p> 
<p><b>60-Ton Hydraulic Press</b> pgs. 521, 522</p> 	<p><b>PE-NUT Electric Two-Speed Pump</b> pg. 527</p> 
<p><b>100-Ton Hydraulic Press</b> pg. 523</p> 	<p><b>Hydraulic Hoses</b> pg. 528</p> 
<p><b>Gas Hydraulic Pump (Manual Control)</b> pgs. 524, 525</p> 	

## Pictorial Index

### COMPRESSION DIES

#### *B Series*

AH, SH: pg. 529 CD: pg. 533



#### *30 Ton Series*

AH, CD, SH: pg. 530



#### *60 Ton Series*

AH, SH, GW: pg. 531 CD: pg. 534

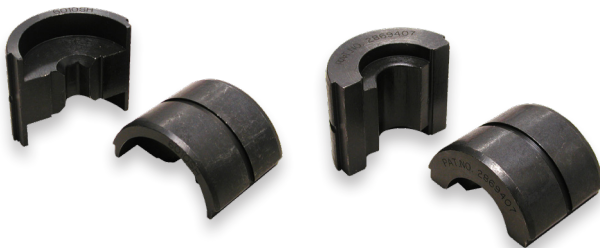

#### *100 Ton Series*

AH, SH: pg. 532 CD: pg. 535





## Model 30A Hydraulic Press



AFL's Model 30A Hydraulic Press is a proven, single-acting hydraulic tool designed for installing connectors with 30 tons of force at 10,000 psi (68.9 MPa).

For versatility, the 30A can be operated in any position and will accommodate any pump capable of supporting this pressure - provided the safety valve setting is between 9,600 psi (66.2 MPa) and 10,400 psi (71.1 MPa).

The large two-inch opening in the C-head permits the Model 30A Hydraulic Press to be hooked over the conductor or accessory and the die-locking devices allow for movement without accidentally dislodging the die halves.

### Features

- Two-inch jaw opening with push button system for easy die insertion and removal
- Operational in any position
- 30 tons of force
- Maximum conductor size of 954 Cardinal
- Pressure matched female quick-coupler supplied along with metal carrying case and die tray
- AH, CD, and SH die sets are available



### Technical Data

PARAMETER	VALUE
Crimping Force	30 US Tons (27.3 Metric Tons)
Operating Pressure	10,000 PSI / 70,000 kPa (700 bar)
Jaw Opening	2.0 in (50.8 mm)
Overall Length	15.0 in (381 mm)
Depth	7.0 in (178 mm)
Head Width	4.0 in (102 mm)
Tool Weight	23 lbs (10.4 kg)
Oil	Simplex hydraulic fluid or equivalent

### Ordering

AFL NO.	DESCRIPTION
30A	30 Ton Remote Tool with Metal Case and Die Tray

**WARNING: Do not operate any compression tool without dies.**

## 60AGSC and 60AFTGSC Hydraulic Press



The 60AGSC and 60AFTGSC presses are portable 60-ton construction and maintenance tools designed to cover a full range of compression accessories requiring die sizes up to and including 40AH. The 60AFTGSC features an integral hinged head with eyes suitable for hot line work.

### Features

- 60 tons of force
- Larger capacity for transmission and distribution applications
- Easy die installation
- Optional hinged flip-top head with eyes suitable for hotline work
- Capacity for all 60 ton U- or shell-type dies
- Metal carrying case
- Lightweight and portable
- Includes ground stand
- Pressure matched female quick coupler supplied

### Technical Data

PARAMETER	VALUE
Crimping Force	62.8 US Tons (57.0 Metric Tons)
Operating Pressure	10,000 PSI
	70,000 kPa (700 bar)
Crimping Capacity	1590 MCM (804.54 mm <sup>2</sup> ) Aluminum and Copper
Overall Length	9.00 in (22.90 cm)
Overall Width	8.50 in (21.60 cm)
Overall Height	17.75 in (45.10 cm)
Tool Weight	42.0 lbs (19.1 kg)

### Ordering

AFL NO.	DESCRIPTION
60AGSC	60 Ton Press with Metal Case and Ground Stand
60AFTGSC	60 Ton Press with Flip-top, Metal Case and Ground Stand

**WARNING: Do not operate any compression tool without dies.**

## 60S/DC Hyrdraulic Press



The 60-Ton Single or Double-Acting Press is unsurpassed in the industry. The compression tool develops 60 tons of force at 10,000 PSI for the installation of electrical compression fittings. The major feature of this tool is a double-acting ram head. The result is more positive retraction, which reduces cycle time. A special piston facilitates operation in single or double-acting mode.

### Features

- 60 tons of force
- Larger capacity for transmission and distribution applications
- Easy die installation
- Double-acting conversion kit included
- Hinged flip-top head
- Carrying handle for portability
- Pressure matched quick couplers supplied
- Metal carrying case

### Technical Data

PARAMETER	VALUE
Crimping Force	62.8 US Tons (57.0 Metric Tons)
Operating Pressure	10,000 PSI
	70,000 kPa (700 bar)
Crimping Capacity	1590 MCM (804.54 mm <sup>2</sup> ) Aluminum and Copper
Overall Length	11.3 in (28.72 cm)
Overall Width	6.0 in (15.24 cm)
Overall Height	17.04 in (43.28 cm)
Tool Weight	72.0 lbs (32.65 kg)

### Ordering

AFL NO.	DESCRIPTION
60S/DC	60 Ton Single/Double Acting Press with Metal Case

**WARNING: Do not operate any compression tool without dies.**

## 100A Hydraulic Press



The 100A Single or Double Acting Press is designed for the installation of compression fittings. The 100A develops 100 tons of force at 10,000 PSI. A special piston facilitates operation in single or double acting mode. Redesigned for portability, the press now weighs 95 pounds.

### Features

- 100 tons of force
- Larger capacity for transmission and distribution applications
- Easy die installation
- Carrying handles for portability
- Capacity for all U or shell-type dies
- Metal carrying case
- Pressure matched quick coupler supplied
- Double acting conversion kit included
- Suspension eye supplied

### Technical Data

PARAMETER	VALUE
Crimping Force	100.0 US Tons (90.8 Metric Tons)
Operating Pressure	10,000 PSI
	70,000 kPa (700 bar)
Crimping Capacity	Up to 3.25 in (8.26 cm) conductor diameter
Overall Width	8.25 in (20.96 cm)
Overall Height	15.00 in (38.10 cm)
Tool Weight	95.0 lbs (43.2 kg)

### Ordering

AFL NO.	DESCRIPTION
100A	100 Ton Single/Double Acting Press with Metal Case

**WARNING: Do not operate any compression tool without dies.**



## 15GBM Gas Hydraulic Pump



The 15GBM is a gas powered pump that produces 10,000 PSI of hydraulic pressure. It is designed to handle any high pressure tool up to and including the 60 ton press. The two-stage pumping system allows for rapid ram advance. The “suc-o-matic” valve helps tools retract faster. The manual control has three settings: advance, hold and retract. Whether making one crimp or 1,000 crimps, the 15GBM is the lightweight, portable answer.

### Features

- 10,000 PSI high-pressure pump
- Powered by a 3.75 HP Briggs and Stratton engine
- Manual control valve
- Designed to operate single acting tools
- High pressure relief valve
- Pressure matched quick coupler supplied
- Protective carrying cage
- “Suc-o-matic” valve reduces retraction time
- Sight gauge to determine hydraulic oil level

### Technical Data

PARAMETER	VALUE
Gas Powered Motor	3.75 HP Briggs and Stratton Engine
Control	Manual control valve
Oil Delivery per minute	400 cu in @ 600 PSI 50 cu in @ 10,000 PSI
Oil Reservoir	2 gallons (7.40 liters)
Overall Length	12.25 in (31.12 cm)
Overall Width	12.25 in (31.13 cm)
Overall Height	20.25 in (51.44 cm)
Pump Weight with oil	53 lbs (24.09 kg)

### Ordering Information

AFL NO.	DESCRIPTION
15GBM	10,000 PSI Gas Powered Hydraulic Pump with Manual Control

**WARNING: Do not operate any compression tool without dies.**

## 30GBM Gas Hydraulic Pump



The 30GBM is a gas powered pump that produces 10,000 PSI of hydraulic pressure. It is designed to operate any 10,000 PSI compression tool. The two-stage pumping system allows for rapid ram advance. The “suc-o-matic” valve helps tools retract faster. The manual control has three settings: advance, hold and retract. The 30GBM is designed for continuous duty.

### Features

- 10,000 PSI high-pressure pump
- Powered by a 6 HP Briggs and Stratton engine
- Manual control valve
- Designed to operate single acting tools only
- High pressure relief valve
- Pressure matched quick coupler supplied
- Protective carrying cage
- Sight gauge to determine hydraulic oil level

### Technical Data

PARAMETER	VALUE
Gas Powered Motor	6.0 HP Briggs and Stratton Engine
Control	Manual control valve
Oil Delivery per minute	430 cu in @ 400 PSI
	125 cu in @ 10,000 PSI
Oil Reservoir	2 gallons (7.40 liters)
Overall Length	21.75 in (55.25 cm)
Overall Width	19.75 in (50.17 cm)
Overall Height	24.50 in (62.23 cm)
Pump Weight with oil	135 lbs (61.36 kg)

### Ordering Information

AFL NO.	DESCRIPTION
30GBM	10,000 PSI Gas Powered Hydraulic Pump with Manual Control

**WARNING: Do not operate any compression tool without dies.**

## 30GHR Gas Hydraulic Pump

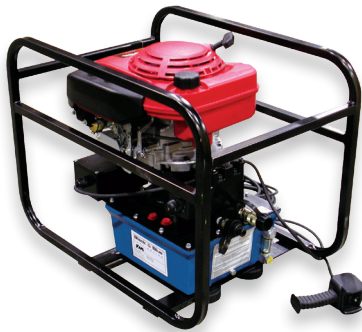

The 30GHR is a gas powered pump that produces 10,000 PSI of hydraulic pressure. The two-stage pumping system allows for rapid ram advance. The unloading pressure of the pump is 1,000 PSI. The 30GHR comes with a remote control with a 10 foot cord and is designed for continuous duty.

### Features

- 10,000 PSI high-pressure pump
- Powered by a 5.5 HP Honda engine
- Remote control with 10 foot cord
- Designed to operate single acting and double acting tools
- High-pressure relief valve
- Pressure matched quick coupler supplied
- Protective carrying cage
- Sight gauge to monitor hydraulic oil level

### Technical Data

PARAMETER	VALUE
Gas Powered Motor	5.5 HP Honda Engine
Control	Remote Control with 10 foot cord
Oil Delivery per minute	430 cu in @ 400 PSI
	125 cu in @ 10,000 PSI
Oil Reservoir	2 gallons (7.40 liters)
Overall Length	21.75 in (55.25 cm)
Overall Width	19.75 in (50.17 cm)
Overall Height	24.50 in (62.23 cm)
Pump Weight with oil	135 lbs (61.36 kg)

### Ordering Information

AFL NO.	DESCRIPTION
30GHR	10,000 PSI Gas Powered Hydraulic Pump with Remote Control

**WARNING: Do not operate any compression tool without dies.**

## PE-NUT Electric Two-Stage Pump



**CAUTION: Designed for Crimping Application Only!** This system should not be used for lifting.

The PE-NUT Electric Two-Stage Pump is extremely durable yet lightweight. It will operate under low-line voltage conditions. The two-stage pumping system of this unique, intermittent-duty pump is designed for years of dependable service. The PE-NUT pump is ideal for running any 10,000 PSI tool up to and including the 60 ton press.

### Features

- 5/8 HP universal electric motor (50/60 cycle)
- Two-stage pump for rapid ram advance
- Operational under low-line voltage conditions
- Optional operating pressures available; consult AFL for details
- Designed for use with spring-returned remote tools
- High-pressure safety relief valve
- Remote hand control with 10-foot cord
- Carrying handle
- Factory filled oil reservoir
- Pressure matched quick-coupler supplied
- Optional carrying case
- Unique, intermittent duty pump
- Piston-type high-pressure pump supercharged by a low-pressure pump

### Specifications

PARAMETER	VALUE
Electric Motor	5/8 HP dual phase, 115 VAC, 50/60 Hz, 11 amps
Electric Control	Remote control with 10-foot cord
Oil Delivery per minute	160 cu. in. per min. @ 100 PSI
	30 cu. in. per min. @ 10,000 PSI
Oil Reservoir	0.4 gallon (1.5 liters)
Overall Length	14.38 in (36.53 cm)
Overall Width	6.5 in (16.51 in)
Overall Height	8.25 in (20.95 in)
Pump Weight with oil	28 lbs (12.70 kg)

### Ordering Information

AFL NO.	DESCRIPTION
PE-NUTC	10,000 PSI Electric Two-Stage Pump with Remote Control and Case

**WARNING: Do not operate any compression tool without dies.**

## Hydraulic Hoses



The 1/4" (0.635 cm) non-conductive, orange hose is made of an insulated, synthetic material. It allows a high flow rate for faster ram movement. Hoses are available with or without couplers for operating pressures of 10,000 PSI with a 4 to 1 burst ratio. Hoses are pre-filled with oil and pressure tested. The hoses are 3/8" NPT male thread on both ends and quick disconnects are 3/8" NPT female.

### Ordering

AFL NO.	DESCRIPTION
6HOSEM/M	6 Foot Hose with Male/male Couplers (1.83 Meters)
10HOSEM/M	10 Foot Hose with Male/male Couplers (3.04 Meters)
15HOSEM/M	15 Foot Hose with Male/male Couplers (4.37 Meters)
25HOSEM/M	25 Foot Hose with Male/male Couplers (7.62 Meters)
6HOSEM/F	6 Foot Hose with Male/female Couplers (1.83 Meters)
10HOSEM/F	10 Foot Hose with Male/female Couplers (3.04 Meters)
15HOSEM/F	15 Foot Hose with Male/female Couplers (4.37 Meters)
25HOSEM/F	25 Foot Hose with Male/female Couplers (7.62 Meters)

**WARNING:** Hoses connecting hydraulic equipment should not extend straight upward more than 25 feet (7.6 meters).

## AH and SH Compression Dies—B Series

COMPRESSION  
DIES



The B Series AH and SH Dies are designed to compress Standard Compression Accessories. These dies are to be used with presses that hold 12-ton dies (U-type).

### Ordering Information

AFL NO.	DIE SECTION	WEIGHT	
		LBS	KG
B11AH	O	0.53	0.24
B-D	D	0.46	0.21
B-N	N	0.22	0.10
B72SH-01SH	01SH	0.59	0.27
B02SH	02SH	0.49	0.22
B74SH-03SH	03SH	0.49	0.22
B04SH	04SH	0.47	0.21
B75SH-05SH	05SH	0.45	0.20
B06AH	06AH	0.72	0.33
B07AH	07AH	0.70	0.32
B73AH-08AH	08AH	0.72	0.33
B09AH	09AH	0.66	0.30
B74AH-10AH	10AH	0.63	0.29
B11AH	11AH	0.53	0.24
B75AH-12AH	12AH	0.49	0.22
B13AH	13AH	0.43	0.20
B20AH-14AH	14AH	0.33	0.15
B15AH	15AH	0.28	0.13
B71AH	71AH	0.72	0.33
B72AH	72AH	0.69	0.31
B72SH-01SH	72SH	0.59	0.27
B73AH-08AH	73AH	0.72	0.33
B73SH	73SH	0.55	0.25
B74AH-10AH	74AH	0.63	0.29
B74SH-03SH	74SH	0.49	0.22
B75AH-12AH	75AH	0.49	0.22
B75SH-05SH	75SH	0.45	0.20
B76AH	76AH	0.38	0.17
B76SH	76SH	0.47	0.21
B76.1SH	76.1SH	0.53	0.24
B10SH	77SH	0.42	0.19
B10SH	10SH	0.42	0.19
B20AH-14AH	20AH	0.33	0.15

**WARNING: Do not operate any compression tool without dies.**

## AH, CD, and SH Compression Dies—30 Ton Series



The 30 Ton AH and SH Dies are designed to compress Standard Compression Accessories and HiTemp™ Compression Accessories. The 30 Ton CD Dies are designed to compress Quick Compress® Accessories. These dies are to be used with the Model 30 A press.

### Ordering Information

AFL NO.	DIE SECTION	WEIGHT	
		LBS	KG
3007CD	07CD	2.2	1.00
3008CD	08CD	2.2	1.00
3009CD	09CD	2.0	.91
3010CD	10CD	2.0	.91
3011CD	11CD	2.0	.91
3000D	D	1.8	.82
3000N	N	1.7	.77
3072SH-01SH	01SH	1.8	.82
3002SH	02SH	1.8	.82
3074SH-03SH	03SH	1.8	.82
3075SH-05SH	05SH	1.8	.82
3006AH	06AH	2.6	1.18
3007AH	07AH	2.4	1.09
3073AH-08AH	08AH	2.4	1.09
3009AH	09AH	2.4	1.09
3074AH-10AH	10AH	2.4	1.09
3011AH	11AH	2.4	1.09
3075H-12AH	12AH	2.2	1.00
3013AH	13AH	2.2	1.00
3020AH-14AH	14AH	1.9	.86
3015AH	15AH	1.8	.82
3071AH	71AH	2.6	1.18
3072AH	72AH	2.6	1.18
3072SH-01SH	72SH	1.8	.82
3073AH-08AH	73AH	2.4	1.09
3073SH	73SH	1.8	.82
3074AH-10AH	74AH	2.4	1.09
3074SH-03SH	74SH	1.8	.82
3075AH-12AH	75AH	2.2	1.00
3075SH-05SH	75SH	1.8	.82
3076AH	76AH	1.9	.86
3076SH	76SH	1.7	.77
3010SH	10SH	1.6	.73
3012SH	12SH	1.6	.73
3014SH	14SH	1.6	.73
3020AH-14AH	20AH	1.9	.86
3024AH	24AH	1.6	.73
3027AH	27AH	1.5	.68
3030AH	30AH	1.3	.59

**WARNING: Do not operate any compression tool without dies.**

## AH, SH and GW Compression Dies—60 Ton Series

COMPRESSION  
DIES



The 60 Ton AH and SH Dies are designed to compress Standard and HiTemp™ Compression Accessories. The GW dies are used to compress fittings for Alu-moweld® and steel ground wire. These dies are to be used with the 60S/DC, 60ASC and 60AFTGSC presses.

### Ordering Information

AFL NO.	DIE SECTION	WEIGHT	
		LBS	KG
6073AH	73AH	4.20	1.91
6074AH	74AH	4.10	1.86
6074SH	74SH	4.10	1.86
6075AH	75AH	4.90	2.22
6075SH	75SH	4.90	2.22
6076AH	76AH	4.70	2.13
6076SH	76SH	3.50	1.59
6076.1SH	76.1SH	3.50	1.59
6010SH	10SH	3.50	1.41
6012SH	12SH	3.30	1.50
6014SH	14SH	3.10	1.41
6016SH	16SH	2.90	1.32
6018SH	18SH	2.80	1.27
6020AH	20AH	4.60	2.09
6020SH	20SH	2.60	1.91
6024AH	24AH	4.20	1.91
6027AH	27AH	3.90	1.77
6030AH	30AH	3.50	1.59
6034AH	34AH	2.90	1.32
6036AH	36AH	2.80	1.27
6038AH	38AH	2.60	1.18
6040AH	40AH	2.20	1.00
6012GW	12GW	3.7	1.68
6014GW	14GW	3.7	1.68
6016GW	16GW	3.7	1.68

**WARNING: Do not operate any compression tool without dies.**



## AH and SH Compression Dies—100 Ton Series



The 100 Ton AH and SH Dies are designed to compress Standard and HiTemp™ Compression Accessories. These dies are to be used with the 100A press.

### Ordering Information

AFL NO.	DIE SECTION	WEIGHT	
		LBS	KG
10074AH	74AH	11.40	5.17
10074SH	74SH	10.00	4.54
10075AH	75AH	11.20	5.08
10075SH	75SH	10.00	4.54
10076AH	76AH	10.70	4.85
10076SH	76SH	9.50	4.31
10010SH	10SH	8.40	3.81
10012SH	12SH	7.90	3.58
10014SH	14SH	7.80	3.54
10016SH	16SH	7.80	3.54
10018SH	18SH	7.50	3.40
10020AH	20AH	10.40	4.72
10020SH	20SH	7.40	3.36
10024AH	24AH	9.80	4.44
10027AH	27AH	9.40	4.26
10030AH	30AH	8.90	4.04
10034AH	34AH	9.40	3.81
10036AH	36AH	8.10	3.67
10038AH	38AH	7.80	3.54
10040AH	40AH	7.60	3.45
10042AH	42AH	6.60	2.99
10044AH	44AH	6.30	2.86
10048AH	48AH	5.40	2.45

**WARNING: Do not operate any compression tool without dies.**

## CD Compression Dies—B Series

COMPRESSION  
DIES



### Ordering Information

AFL NO.	DIE SECTION	WEIGHT	
		LBS	KG
B07CD	07CD	0.57	0.26
B08CD	08CD	0.54	0.24
B09CD	09CD	0.50	0.23

The B Series CD Dies are designed to compress Quick Compress® Accessories. These dies are to be used with presses that hold 12-ton dies (U-type).

**WARNING: Do not operate any compression tool without dies.**

## CD Compression Dies—60 Ton Series



The 60 Ton CD Dies are designed to compress Quick Compress® Accessories. These dies are to be used with the 60S/DC, 60AGSC and 60AFTGSC presses.

### Ordering Information

AFL NO.	DIE SECTION	WEIGHT	
		LBS	KG
6007CD	07CD	4.30	1.95
6008CD	08CD	4.30	1.95
6009CD	09CD	4.10	1.86
6010CD	10CD	3.90	1.77
6011CD	11CD	3.60	1.63
6012CD	12CD	3.30	1.50
6013CD	13CD	3.00	1.63
6014CD	14CD	2.60	1.18
6015CD	15CD	3.20	1.45
6016CD	16CD	3.00	1.36
6017CD	17CD	2.70	1.22

**WARNING: Do not operate any compression tool without dies.**

## CD Compression Dies—100 Ton Series

COMPRESSION  
DIES



The 100 Ton CD Dies are designed to compress Quick Compress® Accessories. These dies are to be used with the 100A press.

### Ordering Information

AFL NO.	DIE SECTION	WEIGHT	
		LBS	KG
10007CD	07CD	11.80	5.35
10008CD	08CD	11.50	5.22
10009CD	09CD	11.10	5.03
10010CD	10CD	10.70	4.85
10011CD	11CD	10.30	4.67
10012CD	12CD	9.80	4.44
10013CD	13CD	9.30	4.22
10014CD	14CD	8.70	3.95
10015CD	15CD	8.10	3.67
10016CD	16CD	7.50	3.40
10017CD	17CD	6.80	3.08
10018CD	18CD	6.10	2.77
10019CD	19CD	6.20	2.81
10020CD	20CD	6.20	2.81

**WARNING: Do not operate any compression tool without dies.**

## Pump and Press Combinations

AFL PRESS	ELECTRIC PUMP	GASOLINE PUMP			HYDRAULIC BOOSTER	
	10AB	15GBM	30GBM	30GHR	250M10C	250MDA10C
14HTR	PC	PC	PC	PC	PC	NR
60AGSC	IC	PC	PC	PC	PC	NR
60AFTGSC	IC	PC	PC	PC	PC	NR
60S/DC	IC	PC	PC	PC	PC	PC
100A	X	BI	PC	PC	PC	PC

**Key**

**BI:** Backup and intermittent

**IC:** Intermittent or continuous duty

**PC:** Production Capability

**X:** Pump reservoir insufficient, not recommended

**NR:** Not Recommended

REFERENCE

**WARNING: Do not operate any compression tool without dies.**

## Tool Safety Information

### Magnaflux Test Requirements

#### For 60 and 100 Ton Presses

Erratic operation or extensive usage requires the inspection / repair by qualified service personnel. For the 60A and 100A Series, after two years of initial service or five thousand cycles, and each year or 2500 cycles thereafter, a magnaflux test should be made on all stress supports and pins. The magnetic particle inspection should be certified and marked on the press in the same area as the serial number. The magnaflux mark should contain 00 (month) 00 (year) - example 0797.

#### Tools that should be magnafluxed:

60AGSC  
60AFTGSC  
100A

### General Usage and Care

#### For 60 and 100 Ton Presses

The 60 Ton and 100 Ton portable compressors are designed for the installation of electrical fittings whether in the shop or in the field. Either single acting (spring returned) or double acting (hydraulically returned) modes are available. Each unit is serial numbered (permanently marked) on the top of the piston housing base. The first two numbers of the serial number indicate the year the press was manufactured.

The greatest single cause of failure for any hydraulic equipment is dirt. Caution should be used to prevent the entry of foreign material into the equipment couplings, die retainers and swivel/locking pins. **OPERATE THE COMPRESSOR ONLY WITH THE TOP SUPPORT CLOSED AND SECURELY IN PLACE. DO NOT OPERATE COMPRESSION TOOLS WITHOUT DIES.**

**WARNING: Do not operate any compression tool without dies.**

## Warranty

AFL warrants to the original purchaser that its product shall be free from defects in material and workmanship as follows: Hand-held and remote compression tools, all pumps and boosters are warranted for one (1) year. Products which are defective and are not misused or abused will be repaired to original specifications free of charge.

Any tool returned under warranty in working condition will be reconditioned once free of charge during the warranty period. Any required repairs will be quoted at preferential pricing at the time of repair.

The warranty card included with each product must be returned to AFL at the time of purchase. AFL uses the same high quality parts for repair as were used in the original manufacture of the product.

Products returned for warranty repair require a return material authorization (RMA), available by phone, fax, mail or e-mail from AFL. All returned products must be shipped freight prepaid. AFL reserves the right to determine all warranty claims. Repair or re-work of parts, equipment or material beyond the warranty period will be done on a quoted basis.

### TERMS OF WARRANTY

This non-transferable warranty does not apply to dies or accessories; in cases of alteration, accident, abuse or misuse; or in cases of disassembly or repair by anyone other than AFL. Failure to maintain purchased products according to the seller's maintenance instructions will invalidate the warranty. The extent of AFL's obligation under the above written warranty is to repair or replace FOB the original point of delivery any products which are defective. No additional remedies are available to the purchaser.

### LIMITATION OF LIABILITY

It is the user's responsibility to adhere to all normal safety procedures and regulations as specified by OSHA, other regulatory bodies and company safety practices and procedures. AFL is not responsible for injuries that occur to users of these products. Except as provided above, AFL MAKES NO OTHER WARRANTIES, EXPRESSED OR IMPLIED, AND SPECIFICALLY DISCLAIMS THE IMPLIED WARRANTIES OR MERCHANTABILITY AND FITNESS FOR PARTICULAR USE. In no event will AFL be liable for more than the purchase price of the product.

This warranty also applies outside the United States and Canada with certain limitations and restrictions. Contact AFL or your local distributor or representative for additional information.

