

For complete installation instructions and video, visit [www.AFLglobal.com/APEX](http://www.AFLglobal.com/APEX) or use the QR code.

## AFL APEX® X-2 MULTI-DROP CABLE ENTRY KIT

Splice modules shown in Apex splice trays. Installation will be similar in all applications.



### Ordering Information

DESCRIPTION	AFL NO.
Multi-Drop Cable Entry Kit (fits up to 4 cables 0.20" to 0.39" in diameter or flat drop cable)	AX-KIT-DROP-4

## PACKAGE CONTENTS

- Apex Multi-Drop (1)
- Blank plugs (3)
- Tie wraps (10) Black UV stabilized supplied in kit
- Cable Attachment Unit (1)
- Hose Clamp (1)
- Spur Bracket (1)

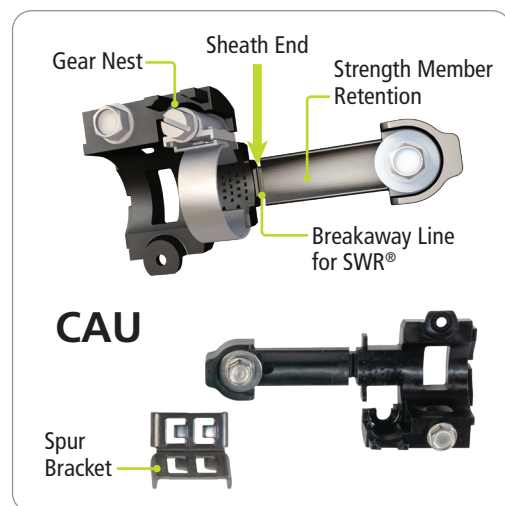

## CABLE ATTACHMENT UNIT

### Parts of the CAU

- Sheath end
- Hose clamp gear nest in CAU
- Strength member retention bolt
- Alignment tab on back
- SWR breakaway line
- Spur bracket and orientation small diameter cable bushing

⊗ **Cable must be clean and free of all tape, dirt or contamination for proper sheath retention and sealing.**

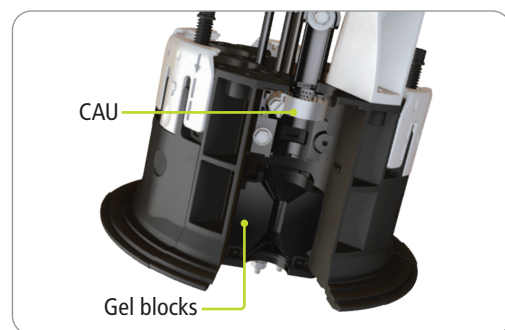

Figure 1

## MULTI-DROP INSTALLATION

The Multi-Drop unit is installed below the CAU encased in the Gel blocks between the plastic gel fingers. (Figure 1)

### Prepare the Multi-Drop Unit

1. Slip 8 tie wraps in unit in opposing directions. (Figure 2)  
Tie wraps at top and bottom in each of the 4 positions as shown (8 total). There is no top or bottom to the kit insert. It can be used in either direction.

⊗ **Black UV stabilized tie wraps are needed and supplied in kit. White tie wraps are used here to show position.**

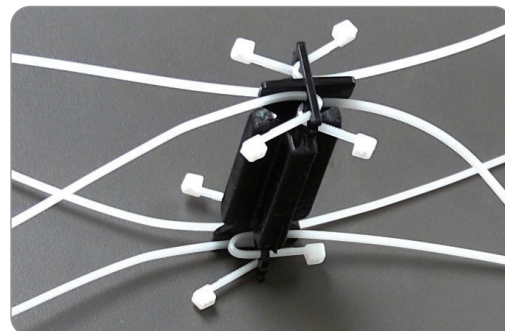

Figure 2

2. Use the length table of the specific product to prepare the drop cable. 90" can used as a default.
3. Install drop cables (flat or round) with 2 ½" from top of the Multi-Drop Kit to sheath end and secure with tie wraps, - 2 per drop.
4. Install blank plugs for any unused drop location and secure with tie wraps - 2 per plug.
5. Secure tie wraps of Multi-Drop Kit to drop cables plugs and snip tails. (Figure 3)
6. Trim all strength members to approximately 3".
  - No need to secure flat drop rods, they can be cut flush.
  - CSM retention can be broken off from the CAU if strength members do not need to be retained.
7. Place the end of the Multi-Drop kit approximately ½" away from the CAU. The end of the drop cables should align closely with the breakaway notch on the CAU. If a combination of drops and plugs are used, the Multi-Drop kit should be rotated so that the plugs face away from the CAU, with the cables closest to the CAU. (Figure 4)
8. Secure all strength rods under Strength Member Retention bolt and washer. (Figure 5)
9. Install Hose clamp and spur bracket, nesting hose clamp in CAU. (Figure 5)
  - The spur bracket MUST be installed with one of the flat tabs aligned with and under the hose clamp gear. (Figure 6A) The proper orientation for the spur opening is towards the splice tray as shown in Figure 5.
  - The spur bracket should NOT be installed as shown in Figure 6B.
10. Secure spur bracket and cable under hose clamp in proper location and tighten with 216 can wrench. (Figure 7)
11. Install the Multi-Drop kit and CAU assembly into base aligning the CAU alignment slot with alignment tab on base. Secure and tighten CAU mount bolt to Base. The Multi-Drop kit seal should be between the base gel fingers. (Figure 8)
12. Depress Base wedge gel and install sealing wedge.

⊗ **Black UV stabilized tie wraps are needed and supplied in kit. White tie wraps are used here to show position.**



Figure 3

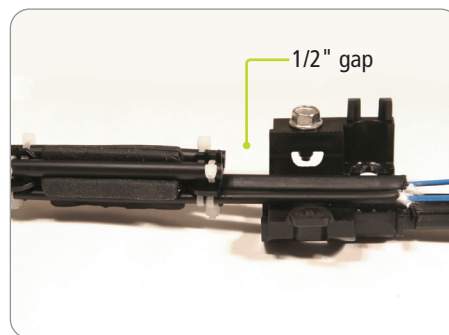

Figure 4

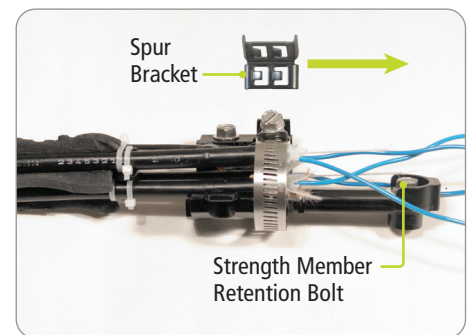

Figure 5

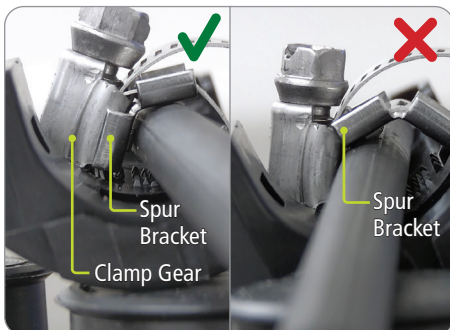

Figure 6A

Figure 6B

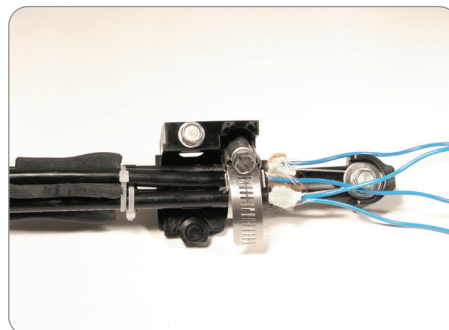

Figure 7

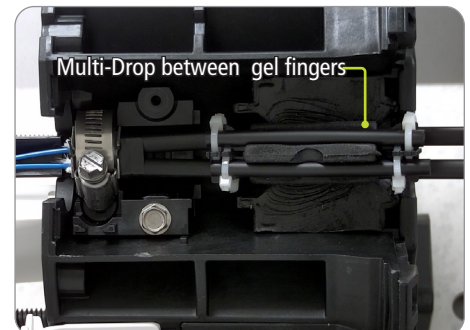

Figure 8