



## Bronze Parallel, Cross, and Bar Taps

### DOSSERT®

#### TYPE GTV

#### Copper Gutter Tap Connector

A variable type gutter tap which accommodates a wide range of cable sizes in both main and tap clamping sections. The variability of this unit minimizes the number of connectors required for a given number of combinations of cables. Compact in design and easy to tape.

#### Material

Copper Alloy

#### Hardware

Everdur bolts and lockwashers

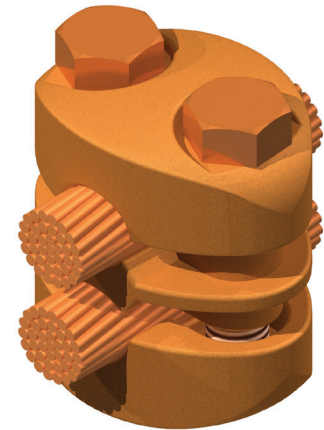

Bronze Parallel, Cross, Bar Taps

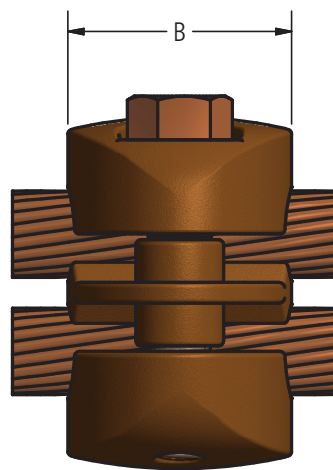
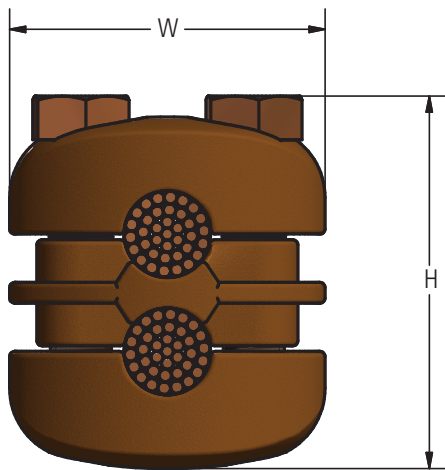



# Bronze Parallel, Cross, and Bar Taps

## DOSSERT®

### TYPE GTV Copper Gutter Tap Connector

#### Ordering Information

CATALOG NUMBER	CONDUCTOR				CLAMPING BOLTS	DIMENSIONS IN INCHES			BOLT SIZE
	RANGE MAIN		RANGE TAP			B	H MAX	W	
	MINIMUM	MAXIMUM	MINIMUM	MAXIMUM					
GTV4-4	8 SOLID	4 STRANDED	8 SOLID	4 STRANDED	2	1 1/8	1 9/16	1 9/16	3/8
GTV6-4	6 STRANDED	2 STRANDED	8 SOLID	4 STRANDED	2	1 1/8	1 9/16	1 9/16	3/8
GTV6-6	6 STRANDED	2 STRANDED	6 STRANDED	2 STRANDED	2	1 1/8	1 9/16	1 9/16	3/8
GTV13-4	3 STRANDED	2/0 STRANDED	8 SOLID	4 STRANDED	2	1 1/8	2	1 3/4	3/8
GTV13-6	3 STRANDED	2/0 STRANDED	6 STRANDED	2 STRANDED	2	1 1/8	1 7/8	1 3/4	3/8
GTV13-13	3 STRANDED	2/0 STRANDED	3 STRANDED	2/0 STRANDED	2	1 1/8	2 1/16	1 3/4	3/8
GTV21-4	1 STRANDED	4/0 STRANDED	8 SOLID	4 STRANDED	2	1 1/8	1 15/16	1 7/8	3/8
GTV21-6	1 STRANDED	4/0 STRANDED	6 STRANDED	2 STRANDED	2	1 1/8	2	1 7/8	3/8
GTV21-13	1 STRANDED	4/0 STRANDED	3 STRANDED	2/0 STRANDED	2	1 1/8	2	1 7/8	3/8
GTV21-21	1 STRANDED	4/0 STRANDED	1 STRANDED	2 STRANDED	2	1 1/8	2 1/8	1 7/8	3/8
GTV35-4	3/0 STRANDED	350 MCM	8 SOLID	4 STRANDED	2	1 3/8	2 1/16	2 1/8	3/8
GTV35-6	3/0 STRANDED	350 MCM	6 STRANDED	2 STRANDED	2	1 3/8	2 1/8	2 1/8	3/8
GTV35-13	3/0 STRANDED	350 MCM	3 STRANDED	2/0 STRANDED	2	1 3/8	2 1/4	2 1/8	3/8
GTV35-21	3/0 STRANDED	350 MCM	1 STRANDED	4/0 STRANDED	2	1 3/8	2 3/8	2 1/8	3/8
GTV35-35	3/0 STRANDED	350 MCM	3/0 STRANDED	350 MCM	2	1 1/4	2 3/16	1 15/16	3/8
GTV50-4	250 MCM	500 MCM	8 SOLID	4 STRANDED	2	1 3/8	2 5/16	2 1/4	3/8
GTV50-6	250 MCM	500 MCM	6 STRANDED	2 STRANDED	2	1 3/8	2 3/8	2 1/4	3/8
GTV50-13	250 MCM	500 MCM	3 STRANDED	2/0 STRANDED	2	1 3/8	2 1/2	2 1/4	3/8
GTV50-21	250 MCM	500 MCM	1 STRANDED	4/0 STRANDED	2	1 3/8	2 3/4	2 1/4	3/8
GTV50-35	250 MCM	500 MCM	3/0 STRANDED	350 MCM	2	1 3/8	2 7/8	2 1/4	3/8
GTV50-50	250 MCM	500 MCM	250 MCM	500 MCM	4	1 3/4	2 15/16	2 1/4	3/8
GTV80-4	400 MCM	800 MCM	8 SOLID	4 STRANDED	2	1 1/2	2 7/16	2 1/2	3/8
GTV80-6	400 MCM	800 MCM	6 STRANDED	2 STRANDED	2	1 1/2	2 1/2	2 1/2	3/8
GTV80-13	400 MCM	800 MCM	3 STRANDED	2/0 STRANDED	2	1 1/2	2 5/8	2 1/2	3/8
GTV80-21	400 MCM	800 MCM	1 STRANDED	4/0 STRANDED	2	1 1/2	2 3/4	2 1/2	3/8
GTV80-35	400 MCM	800 MCM	3/0 STRANDED	350 MCM	2	1 1/2	2 7/8	2 1/2	3/8
GTV80-50	400 MCM	800 MCM	250 MCM	500 MCM	4	1 3/4	3	2 1/2	3/8
GTV80-80	400 MCM	800 MCM	400 MCM	800 MCM	4	1 3/4	3 1/4	2 1/2	3/8
GTV100-4	500 MCM	1000 MCM	8 SOLID	4 STRANDED	2	1 1/2	2 9/16	2 5/8	3/8
GTV100-6	500 MCM	1000 MCM	6 STRANDED	2 STRANDED	2	1 1/2	2 5/8	2 5/8	3/8
GTV100-13	500 MCM	1000 MCM	3 STRANDED	2/0 STRANDED	2	1 1/2	2 3/4	2 5/8	3/8
GTV100-21	500 MCM	1000 MCM	1 STRANDED	4/0 STRANDED	2	1 1/2	2 7/8	2 5/8	3/8
GTV100-35	500 MCM	1000 MCM	3/0 STRANDED	350 MCM	2	1 1/2	3	2 5/8	3/8
GTV100-50	500 MCM	1000 MCM	250 MCM	500 MCM	4	1 3/4	3 1/8	2 5/8	3/8
GTV100-80	500 MCM	1000 MCM	400 MCM	800 MCM	4	1 3/4	3 3/8	2 5/8	3/8
GTV100-100	500 MCM	1000 MCM	500 MCM	1000 MCM	4	1 3/4	3 1/2	2 5/8	3/8
GTV150-4	850 MCM	1500 MCM	8 SOLID	4 STRANDED	2	1 3/4	3 5/16	2 7/8	3/8
GTV150-6	850 MCM	1500 MCM	6 STRANDED	2 STRANDED	2	1 3/4	3 3/8	2 7/8	3/8
GTV150-13	850 MCM	1500 MCM	3 STRANDED	2/0 STRANDED	2	1 3/4	3 1/2	2 7/8	3/8
GTV150-21	850 MCM	1500 MCM	1 STRANDED	4/0 STRANDED	2	1 3/4	3 5/8	2 7/8	3/8
GTV150-35	850 MCM	1500 MCM	3/0 STRANDED	350 MCM	2	1 3/4	3 3/4	2 7/8	3/8
GTV150-50	850 MCM	1500 MCM	250 MCM	500 MCM	4	1 3/4	3 7/8	2 7/8	3/8
GTV150-80	850 MCM	1500 MCM	400 MCM	800 MCM	4	1 3/4	4	2 7/8	3/8
GTV150-100	850 MCM	1500 MCM	500 MCM	1000 MCM	4	1 3/4	4 1/8	2 7/8	3/8
GTV150-150	850 MCM	1500 MCM	850 MCM	1500 MCM	4	2 1/4	4 3/8	3 1/4	1/2
GTV200-4	1200 MCM	2000 MCM	8 SOLID	4 STRANDED	2	2	3 3/16	3	3/8
GTV200-6	1200 MCM	2000 MCM	6 STRANDED	2 STRANDED	2	2	3 1/4	3	3/8
GTV200-13	1200 MCM	2000 MCM	3 STRANDED	2/0 STRANDED	2	2	3 3/8	3	3/8
GTV200-21	1200 MCM	2000 MCM	1 STRANDED	4/0 STRANDED	2	2	3 1/2	3	3/8
GTV200-35	1200 MCM	2000 MCM	3/0 STRANDED	350 MCM	4	2 3/8	3 15/16	3 1/4	3/8
GTV200-50	1200 MCM	2000 MCM	250 MCM	500 MCM	4	2 1/4	3 15/16	3	3/8
GTV200-80	1200 MCM	2000 MCM	400 MCM	800 MCM	4	2	4	3	3/8
GTV200-100	1200 MCM	2000 MCM	500 MCM	1000 MCM	4	2	4 1/4	3	3/8
GTV200-150	1200 MCM	2000 MCM	850 MCM	1500 MCM	4	2 1/4	4 1/2	3 1/2	3/8
GTV200-200	1200 MCM	2000 MCM	1200 MCM	2000 MCM	4	2 1/4	4 3/4	3 1/2	1/2

Bronze Parallel, Cross, Bar Taps