

AGC Series ADSS Downlead Clamp

AFL's AGC Series Downlead Clamps are used to guide ADSS Fiber Optic Cable from the top of the structure to the splice location. Our clamps install easily and provide proper spacing and hold strength without damage to the cable. From poles to towers, we offer a full line of ADSS Downlead Clamps to meet the needs of any application.

Features

- Compressive elastomer material protects cable jacket
- Galvanized lag screw, square curved washer and standard round washers included
- BABA compliant

Ordering Information

AFL No.	Groove Code	Cable Diameter (inches)		Dimensions (inches)
		Min.	Max.	A
AGC468468D	468	0.375	0.468	2.75
AGC562562D	562	0.469	0.562	2.75
AGC656656D	656	0.563	0.656	2.75
AGC750750D	750	0.657	0.750	2.75
AGC849849D	849	0.751	0.849	3.00
AGC948948D	948	0.850	0.948	3.00
AGC105105D	105	0.949	1.050	3.00

* For BABA-compliant part number, add "-BABA" to end of part number.

Note: Alternative configurations are available. Please contact AFL for additional information.



AGC Series ADSS Downlead Clamp
with galvanized steel hardware

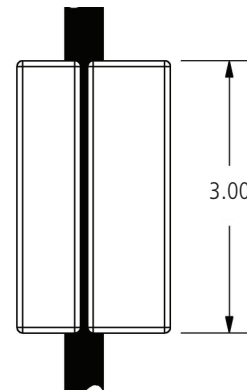
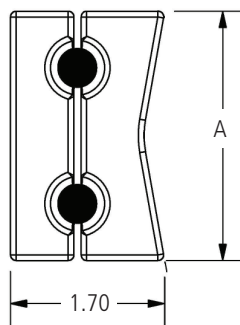
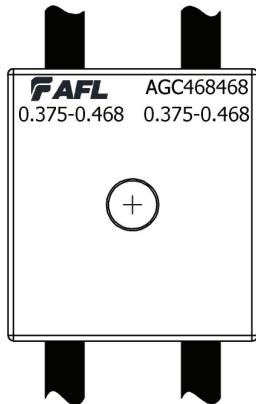
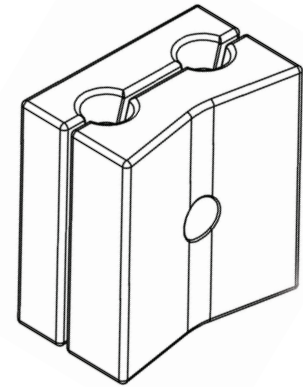

BABA compliant configurations and part numbers indicated where applicable.
For complete list of compliant part numbers, see [AFL BABA Compliant Equipment List](#) on our website.