

DOSSERT®

TYPE CAP

Bus Support for Tubular Bus To Insulator Cap

A two piece high strength bronze cable support which mounts conductor to cap of insulator. Furnished with cap screws for threading into tapped holes on insulator. For base mounting, if specified, bolts and nuts will be furnished. When ordering specify conductor size to be employed so that correct length of bolt can be supplied.

Material

Copper Alloy

Hardware

Everdur bolts and lockwashers

Notes

- For Electro Tin Plate, add "-SN" to catalog number. EX: CAP21-3-SN

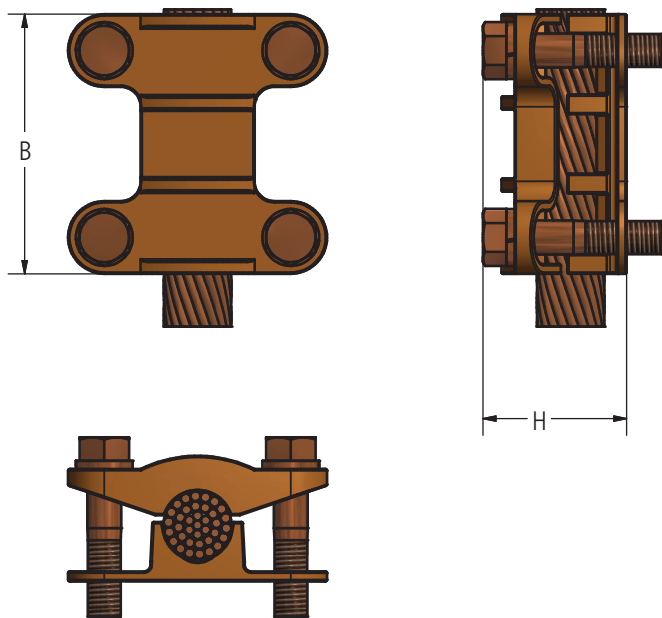
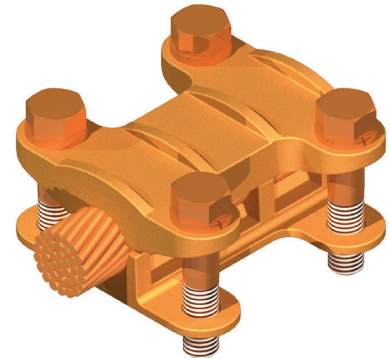

Ordering Information

CATALOG NUMBER	CABLE RANGE		BOLT CIRCLE	DIMENSIONS IN INCHES		
	MIN	MAX		B	H	BOLT SIZE
CAP21-3	2 Stranded	4/0 Stranded	3	3 1/4	1 9/16	1/2
CAP21-5	2 Stranded	4/0 Stranded	5	4 15/16	1 13/16	5/8
CAP50-3	2/0 Stranded	500 kcmil	3	3 1/4	1 13/16	1/2
CAP50-5	2/0 Stranded	500 kcmil	5	4 15/16	2 1/16	5/8
CAP125-3	550 kcmil	1250 kcmil	3	3 1/4	2 3/16	1/2
CAP125-5	550 kcmil	1250 kcmil	5	4 15/16	2 3/4	5/8

DOSSERT[®] TYPE CBP

Two Unit Bus Support For Cable

A two unit four piece high strength bronze cable support which mounts conductor to cap of insulator. A single unit for light service can be supplied on request. Clamp is furnished with cap screws for threading into tapped holes of insulator. Specify conductor size when ordering in order that correct length of cap screw or bolt can be supplied.

Material

Copper Alloy

Hardware

Everdur bolts and lockwashers

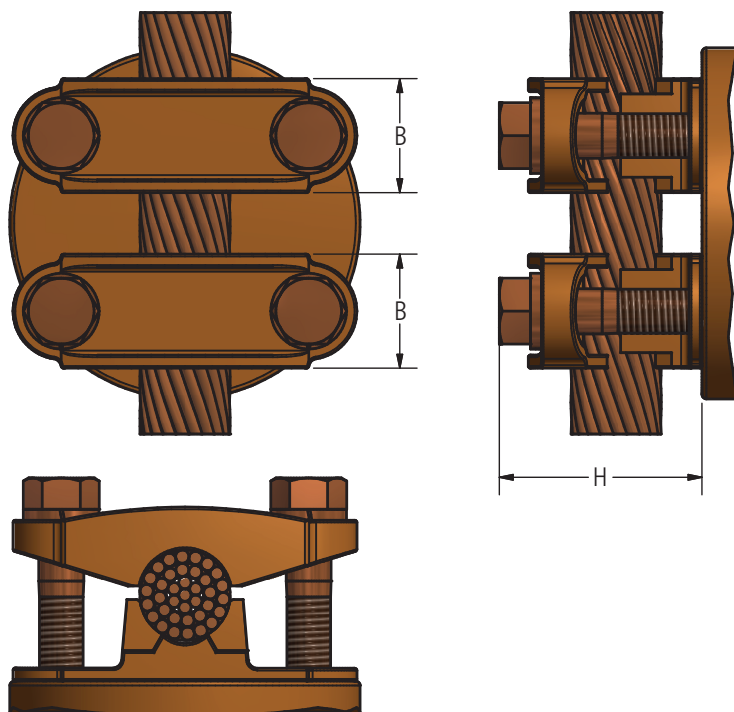
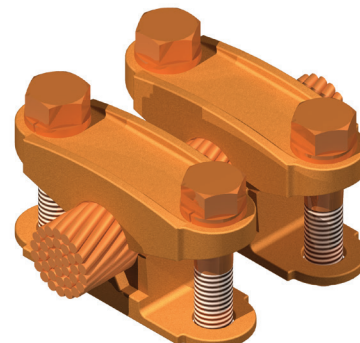

Ordering Information

CATALOG NUMBER	CABLE RANGE		DIMENSIONS IN INCHES			
	MIN	MAX	BOLT CIRCLE	B	H	BOLT SIZE
CBP21-3	2 Stranded	4/0 Stranded	3	1 1/8	1 9/16	1/2
CBP21-5	2 Stranded	4/0 Stranded	5	1 3/8	1 13/16	5/8
CBP50-3	2/0 Stranded	500 kcmil	3	1 1/8	1 13/16	1/2
CBP50-5	2/0 Stranded	500 kcmil	5	1 3/8	2 1/16	5/8
CBP125-3	550 kcmil	1250 kcmil	3	1 3/8	2 3/16	1/2
CBP125-5	550 kcmil	1250 kcmil	5	1 5/8	2 3/4	5/8

DOSSERT®

TYPE CS

Bus Support Clamp For Cable Conductor

A high strength bronze bus support clamp for cable conductor. For securing to insulator, bolts and nuts are furnished for pin and slotted cap mountings, and cap screws for cap mountings. When ordering specify type of mountings to be used and also cable size to determine clamping bolt length.

Material

Copper Alloy

Hardware

Everdur bolts, nuts and lockwashers

Mounting hardware galvanized steel

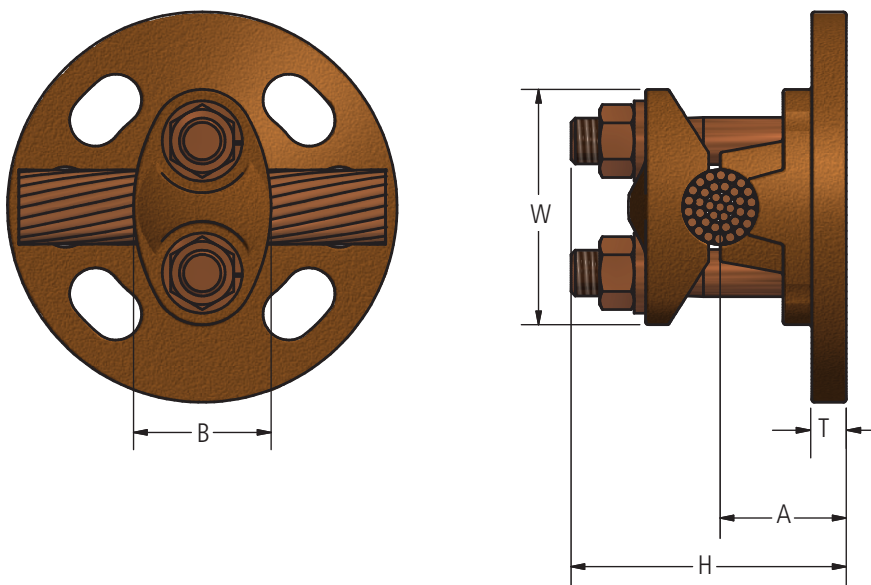
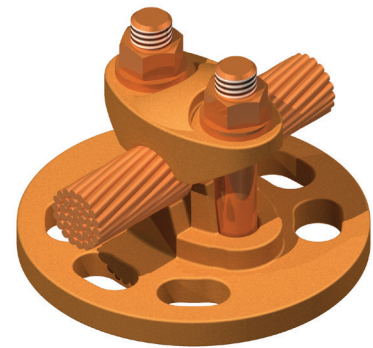

Ordering Information

CATALOG NUMBER	CONDUCTOR RANGE				BOLT CIRCLE	DIMENSIONS IN INCHES					
	CABLE		SPS			A	B	H	W	T	BOLT SIZE
	MIN	MAX	MIN	MAX							
CS21-3	6 Solid	4/0 Stranded	—	—	3	1 1/4	1 1/2	2 9/16	1 15/16	7/32	3/8
CS21-5	6 Solid	4/0 Stranded	—	—	5	1 1/4	1 1/2	2 9/16	1 15/16	7/32	3/8
CS50-3	2/0 Stranded	500 kcmil	1/4	1/2	3	1 3/8	1 1/2	2 5/8	2 3/16	3/8	3/8
CS50-5	2/0 Stranded	500 kcmil	1/4	1/2	5	1 3/8	1 1/2	2 5/8	2 3/16	3/8	3/8
CS125-3	550 kcmil	1250 kcmil	1/2	1	3	1 9/16	1 3/4	3 1/4	3 1/4	3/8	1/2
CS125-5	550 kcmil	1250 kcmil	1/2	1	5	1 9/16	1 3/4	3 1/4	3 1/4	3/8	1/2
CS200-3	1300 kcmil	2000 kcmil	1	1 1/4	3	1 7/8	1 3/4	3 7/16	3 1/2	3/8	1/2
CS200-5	1300 kcmil	2000 kcmil	1	1 1/4	5	1 7/8	1 3/4	3 7/16	3 1/2	3/8	1/2

DOSSERT®

TYPE CVSP Cable Bus Support

Material

Copper Alloy

Hardware

Everdur bolts, nuts and lockwashers
Mounting hardware galvanized steel

Note

For less mounting hardware add suffix
'LMH' to catalog number.

Ex: CVSP143A-5-LMH

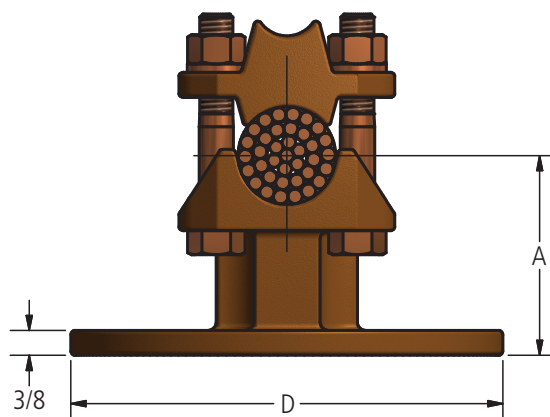
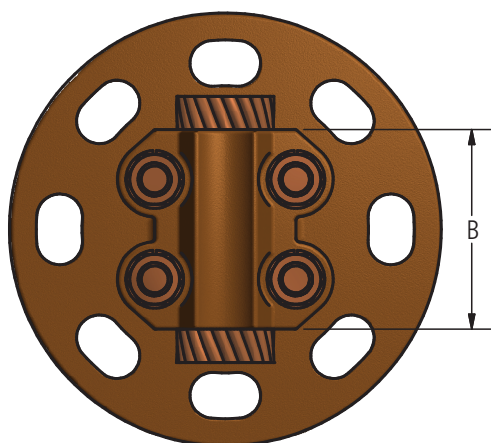
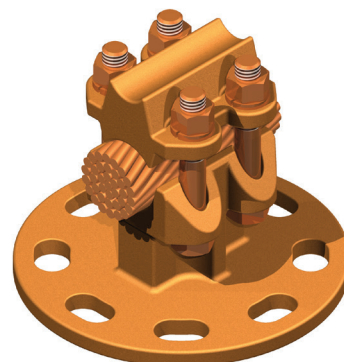

Ordering Information

CATALOG NUMBER	CABLE RANGE				SPS RANGE		DIMENSIONS IN INCHES			
	SMALL GROOVE		LARGE GROOVE		SMALL GROOVE	LARGE GROOVE	BOLT CIRCLE	A	B	D
	MIN	MAX	MIN	MAX						
CVSP143-3	3/0 STR	700 MCM	715.5 MCM	1431 STR	1/4	1	3	3 1/4	3	4 1/4
CVSP143-5	3/0 STR	700 MCM	715.5 MCM	1431 STR	1/4	1	5	3	3	6 1/4

DOSSERT® TYPE PSRE

Low Mounting Variable Bus Support

An inexpensive low mounting variable bus support clamp. The wide range of conductor sizes accommodated by a reversible cap minimizes the number of clamps to cover a given range of bus sizes. Furnished complete with cap screws for cap mounting or with bolts, nuts, and lockwashers for base mounting.

Material

Copper Alloy

Hardware

Everdur bolts, nuts and lockwashers
Mounting hardware galvanized steel

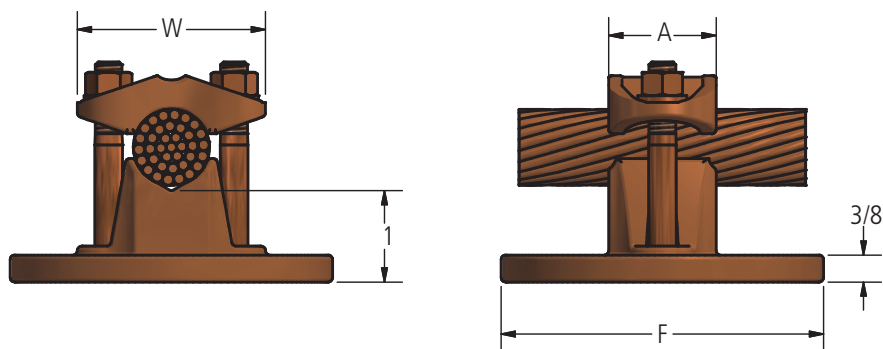
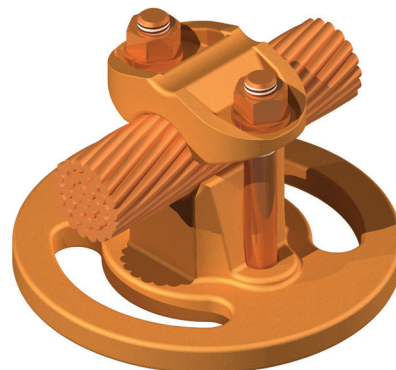

Ordering Information

CATALOG NUMBER	CABLE RANGE		DIMENSIONS IN INCHES				
	MIN	MAX	BOLT CIRCLE	A	F	W	BOLT SIZE
PSRE75-3	1/4	1 1/16	3	1 1/2	4 1/4	2 1/2	3/8
PSRE125-3	13/16	1 11/16	3	1 5/8	4 1/4	3 1/2	1/2
PSRE200-3	1 5/8	2 3/8	3	1 5/8	4 1/4	4 1/4	1/2
PSRE75-5	1/4	1 1/16	5	1 1/2	6 1/4	2 1/2	3/8
PSRE125-5	13/16	1 11/16	5	1 5/8	6 1/4	3 1/2	1/2
PSRE200-5	1 5/8	2 3/8	5	1 5/8	6 1/4	4 1/4	1/2