

DOSSERT®

Type NRLA-PL3 Long Limiter Link for Paper Insulated Cable*

The long limiter link has a dual function of serving as a connecting coupler as well as a fuse. The fusible section determines the time-current characteristics of each size. This is made to close tolerances to insure consistent conformity with the fusing time-current curves. The limiter will not clear the circuit on system overloads but will clear the circuit on faults severe enough to cause cable insulation damage.

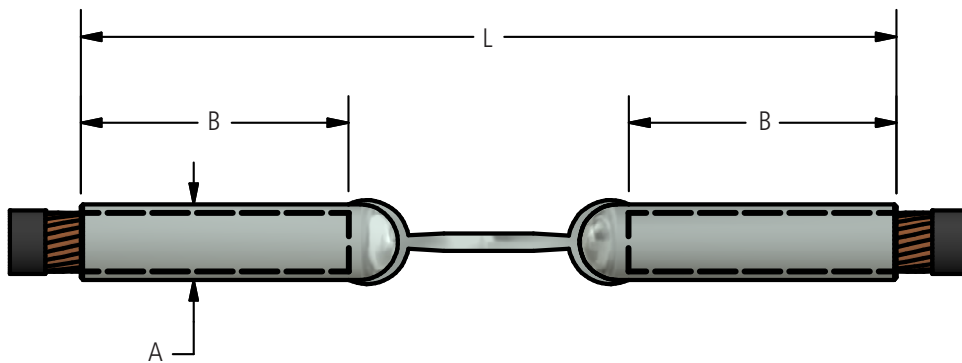
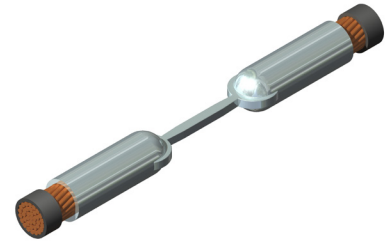

Ordering Information

CATALOG NUMBER	CABLE SIZE	INDENTS IN CABLE SOCKET	DIMENSIONS IN INCHES		
			A**	B	L
NRLA21-PL3	4/0 STR	1	11/16	3	8 7/8
NRLA25-PL3	250 MCM	1	3/4	3 1/8	8 7/8
NRLA30-PL3	300 MCM	2	13/16	3 1/2	9 5/8
NRLA35-PL3	350 MCM	2	7/8	3 1/2	9 5/8
NRLA40-PL3	400 MCM	2	31/32	3 1/2	9 5/8
NRLA50-PL3	500 MCM	2	1 1/16	4 1/4	11 1/2
NRLA75-PL3	750 MCM	2	1 5/16	4 1/4	11 3/4

* Closed end of sockets are sealed to make sockets oil tight.

** Diameter.