

THIS DRAWING AND ALL INFORMATION ON IT IS THE PROPERTY OF AFL. IT IS CONFIDENTIAL AND IT IS GIVEN TO YOU FOR A LIMITED PURPOSE AND MUST BE RETURNED UPON REQUEST. NEITHER THIS DRAWING OR ANY PART OF IT NOR ANY INFORMATION CONCERNING IT MAY BE COPIED, EXHIBITED, OR FURNISHED TO OTHERS NOR PHOTOGRAPHS TAKEN OF ANY ARTICLE FABRICATED OR ASSEMBLED FROM THE DRAWING WITHOUT THE CONSENT OF AFL.

ITEM NO:

DWG. NO:

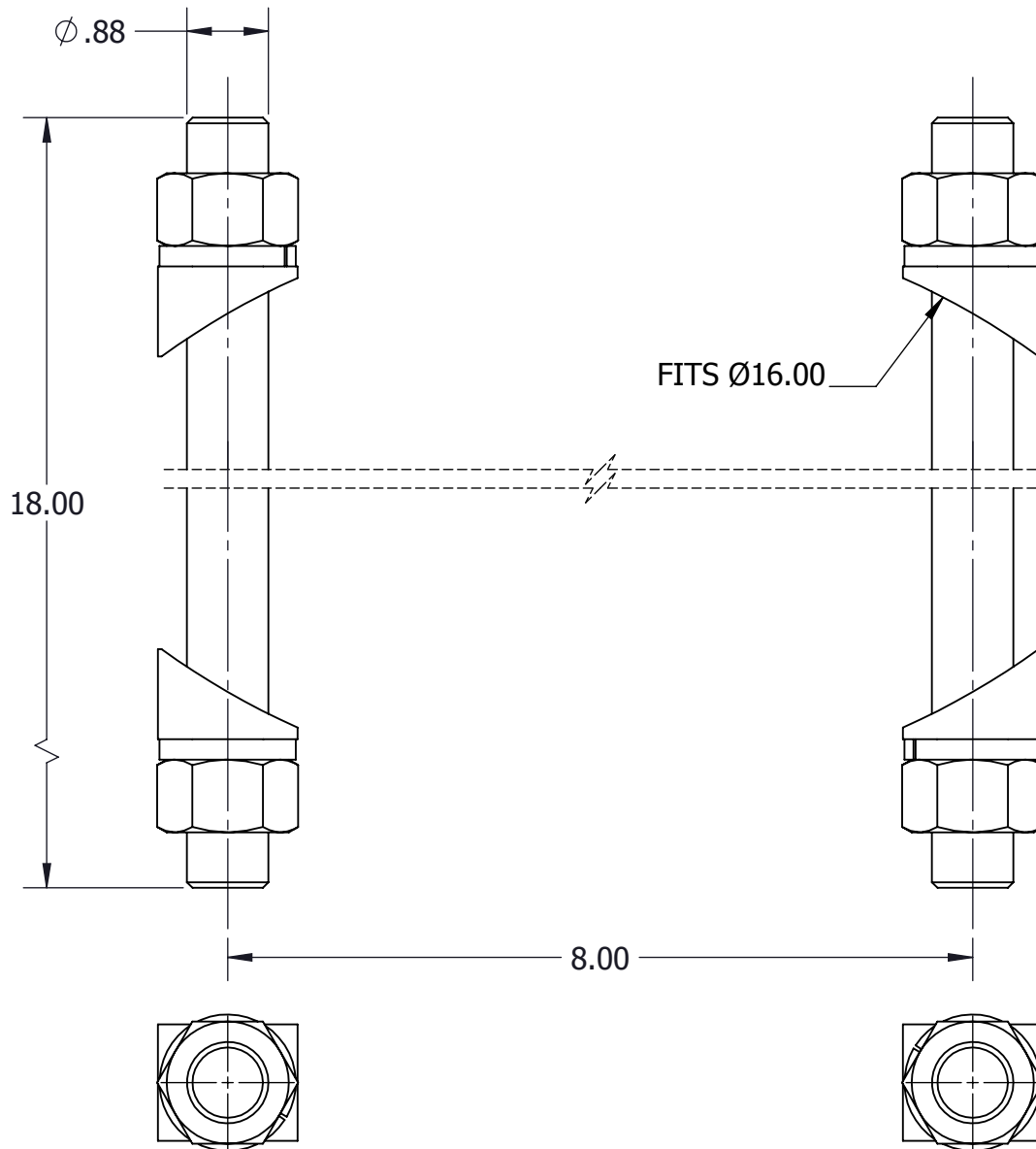

**MATERIAL:**

STUDS - STEEL, ASTM A29, H.D.G\*

CURVED WASHER - ALUMINUM BRONZE, ASTM B30

HEX NUTS & LOCKWASHERS - STEEL, H.D.G\*

**NOTE:**

2 ITEMS PER SET

BOLT SIZES	WRENCH/SOCKET SIZES	TORQUE VALUES (FT-LBS)
7/8-9	1 5/16 HEX	194

WT: 8.0 LB

\* = HOT DIP GALVANIZED

LOCATION

CONTRACT NO

CUST / CONTR

REVISIONS

REV	DESCRIPTION	DATE	BY	APR

DRN BY:  
AY

DRN DATE:  
7.20.17

CHK BY:  
JL

CHK DATE:  
7.20.17

PA 2015.231.0

**AFL DOSSERT®**

BWA, STOP, LOW TEMPERATURE, THRU POLE  
MTG, RND POLE

REV  
0

PART NO:

BWA-LTS-01

1 OF 1