

Typical configuration for a lattice tower

SkyWrap® In-line Joint—Ground Wire

Cable is passed down the tower to a cable joint enclosure in a protective conduit. It then passes back up to the ground wire via a conduit for the continued SkyWrap connection.

The joint enclosure is mounted on lattice towers, wood, steel or concrete poles for easy access to the fiber.

Features

- All tower fittings are available for a range of tower or pole designs
- Enclosures boxes are 830 x 380 x 260 mm
- Convenient cable storage and easy access to joint
- Robust weather proof design
- Available for up to 192 fibers
- Joint enclosure can be locked for added security

Key components

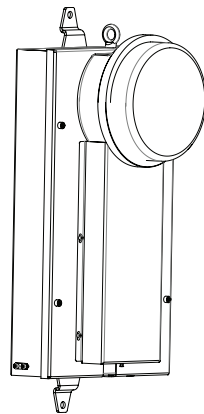

Tower mounted joint enclosure

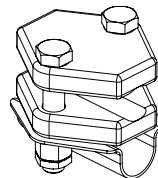

Ground to ground clamp

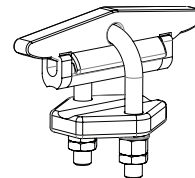

Cable clamp with nylon insert

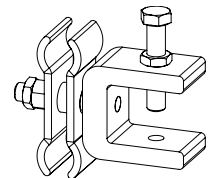

Conduit clamp

Ordering Information

	TOWER HEIGHT feet (m)			STRUCTURE TYPE			CONDUCTOR SIZE inches (mm)			FIBER COUNT
	< 82 (< 25)	< 115 (< 35)	< 197 (< 60)	Lattice Tower	Steel/Concrete Pole	Wood Pole	0.354-0.866 (9-22)	0.787-1.221 (20-31)	1.181-1.693 (30-43)	
TCD	L	M	H	901	905	961	A	B	C	nnF

Example: TCD-L901B48F

Qualifications

GOVERNING BODY	STANDARD CODE
BS EN	50411-3-2002
IEEE	1591.3-2011